

State Trust Land Lease

AVAILABLE FOR PUBLIC AUCTION



10/6/2021 Detail Map

WASHINGTON STATE DEPARTMENT OF
NATURAL RESOURCES

For cartographic display only, DNR reserves the right to revise, edit or otherwise modify.

Lease No. C1200A88961

T7-0N R25-0E S36, Benton County

Precipitation Inches/Year: 8-10

0 330 660 1,320 Feet

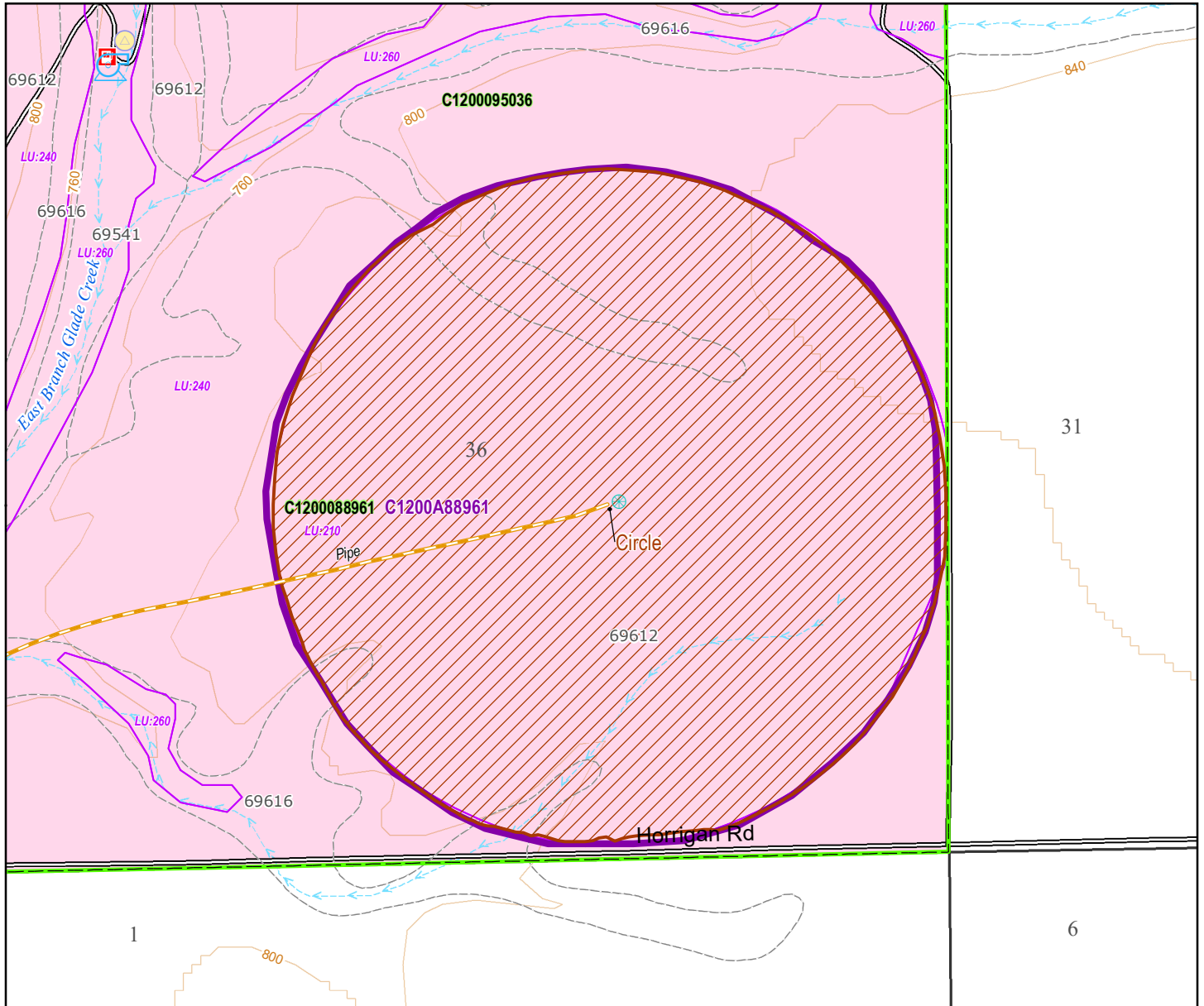

- AG lease Future
- AG lease Current
- WELL
- PIVOT
- PUMP
- ELECTRIC_PANEL
- PIPE

- Land Use
- 210: Agriculture - Irrigated
- 240: Agriculture - Dryland (not irrigated)
- 260: Agriculture - Non-productive land

- NRCS Soils (MUKEY__MUNAME)
- 69612__Warden silt loam, 0 to 5 percent slopes
- 69616__Warden silt loam, 15 to 30 percent slopes, severely eroded