



WASHINGTON STATE DEPARTMENT OF  
**Natural Resources**  
Peter Goldmark - Commissioner of Public Lands

## Application for Use of State-owned Aquatic Lands

<b>Applicant Name:</b>	City of Kent
<b>County:</b>	King County
<b>Water Body:</b>	Green River
<b>Type of Authorization/Use:</b>	Conservation License/Salmon Habitat Restoration
<b>Authorization Number:</b>	23-091141
<b>Term:</b>	5 years
<b>Description:</b>	This agreement will authorize use of state-owned aquatic lands for the sole purpose of salmon habitat enhancement under the Downey Farmstead Restoration Project. The proposed use is located on the Green River, King County, Washington.



MEMBERS OF CITY COUNCIL

DANA RALPH

LES THOMAS

PAT FITZPATRICK - CITY ATTORNEY

JOB NUMBER 08-3017

SHEET INDEX	
NO.	SHEET TITLE
C-14	PARKING AREA PLAN AND DETAILS
C-15	HABITAT STRUCTURE TYPE 1 AND 2 PLAN AND SECTION
C-16	ENGINEERED LOG JAMS TYPE 3 PLAN AND SECTION
C-17	ENGINEERED LOG JAM TYPE 3 LAYERING PLAN
C-18	LOW FLOW EDDY HABITAT STRUCTURE PLAN AND SECTION
EC-1	TESS AND WATER MANAGEMENT PLAN – WEST
EC-2	TESS AND WATER MANAGEMENT PLAN – EAST
EC-3	TESS AND WATER MANAGEMENT PLAN – PARKING AREA
EC-4	TESS AND WATER MANAGEMENT DETAILS AND NOTES – 1 OF 2
EC-5	TESS AND WATER MANAGEMENT DETAILS AND NOTES – 2 OF 2
P-1	PLANTING PLAN – WEST
P-2	PLANTING PLAN – EAST
P-3	PLANTING SCHEDULE AND NOTES
P-4	PLANTING DETAILS

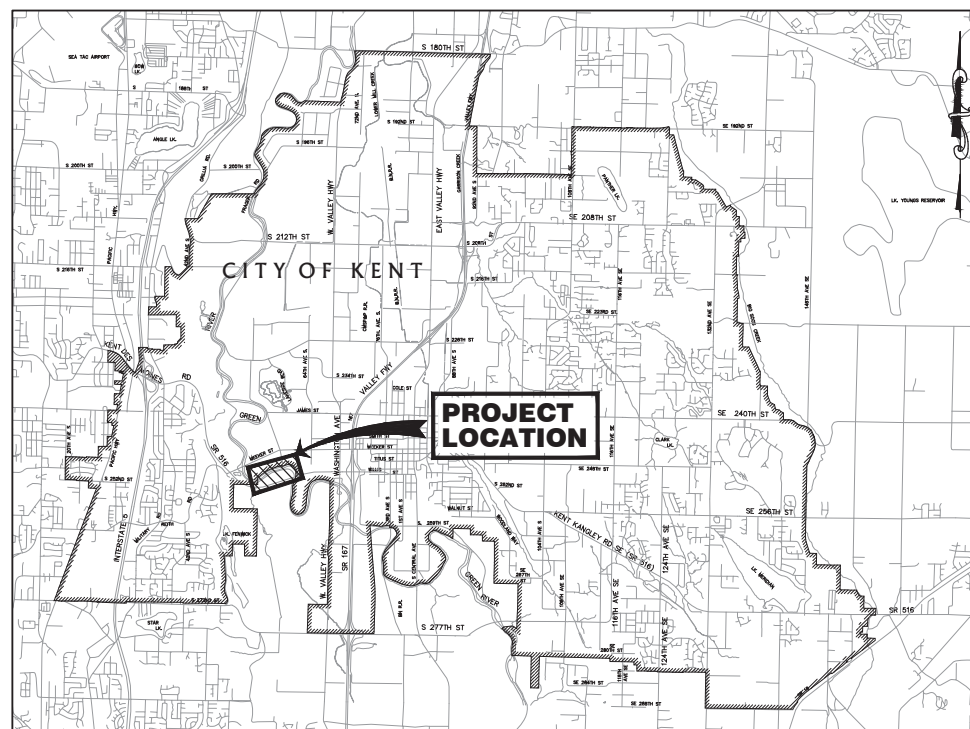

VICINITY MAP  
NOT TO SCALE



SW 1/4 SEC. 23, T. 22N, R. 4E., W.M.

SE 1/4 SEC. 23, T. 22N, R. 4E., W.M.

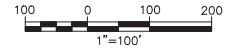
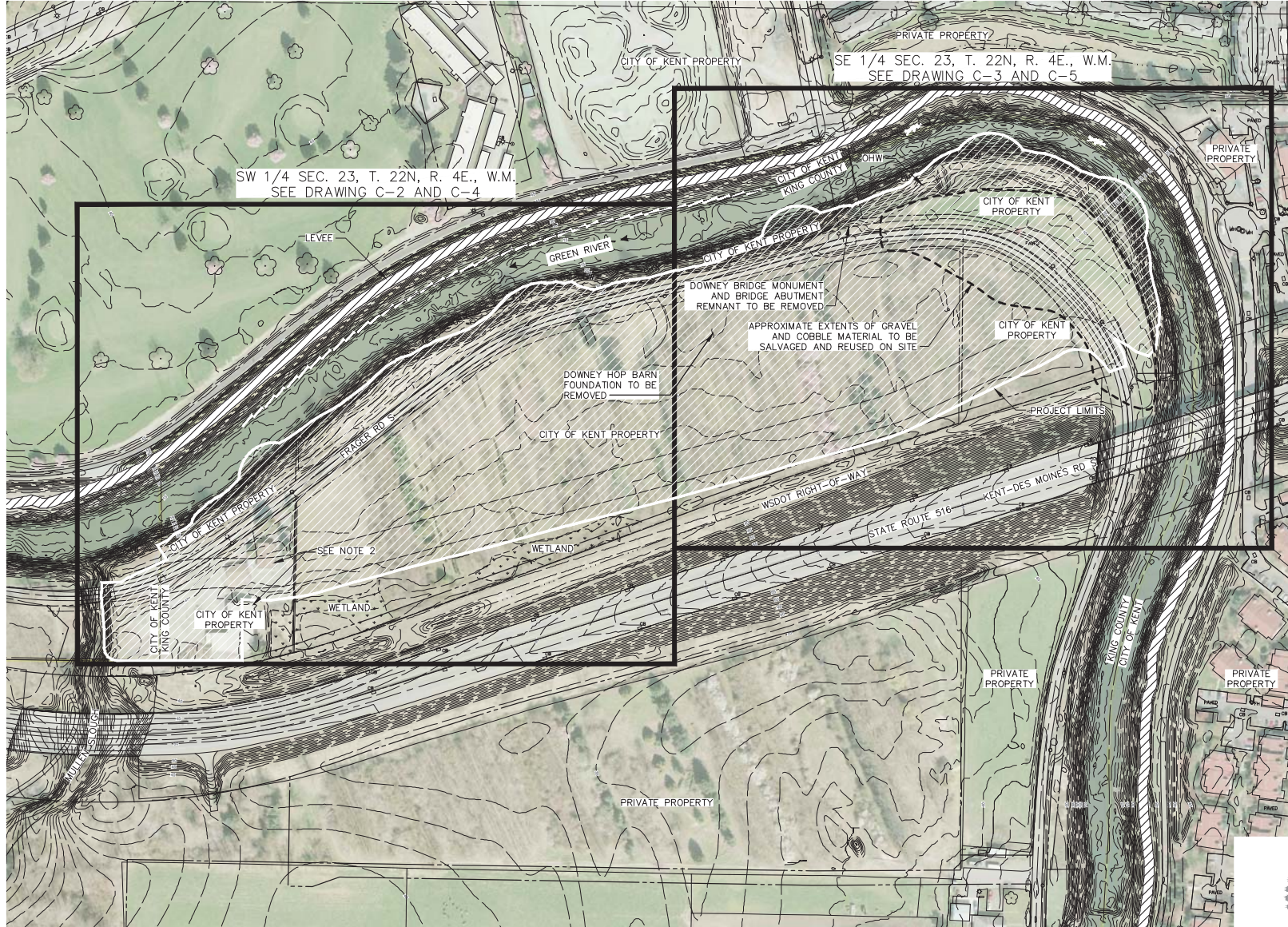

**NOTES:**

1. SITE ELEVATION DATA WAS PROVIDED BY CITY OF KENT, 4/2010. BATHYMETRIC DATA WAS SURVEYED BY PGS 2/2010. AERIAL PHOTO IS FROM 2009 AND PROVIDED BY THE CITY OF KENT.
2. THESE BUILDINGS AND SUBSTRUCTURES HAVE BEEN REMOVED FROM THE PROJECT AREA.

Plot Date: 1/3/2014 1:47 PM  
 User: UserWadsworth, China  
 Plot Size: 1000x1000  
 Plotter: DWF to PDF v3.3

DESIGNED: M.B.	CHECKED: M.E.	KENT PROJECT NO. 09-3017	SCALE: HORIZ. NOTED
DRAWN: R.H.	PROJECT ENGR: M.E.	CONST. MGMT. REVIEW	VERT: _____
APPROVED: _____	CITY ENGINEER	DATE NOV. 2013	

BAR IS ONE INCH ON ORIGINAL DRAWING ADJUST SCALES ACCORDINGLY  
 0" 1"



City of Kent  
 Public Works Department  
 Engineering Division

EXISTING SITE PLAN AND KEY MAP

DOWNEY FARMSTEAD  
 RESTORATION



2200 Sixth Avenue  
 Suite 1100  
 Seattle, Washington  
 98121-1820  
 206-441-9080  
 206-441-9108 FAX  
<http://www.herrerainc.com>

SHEET
C-1 OF 29
FILE NO. 0187C01