

State Uplands Viewing Tool

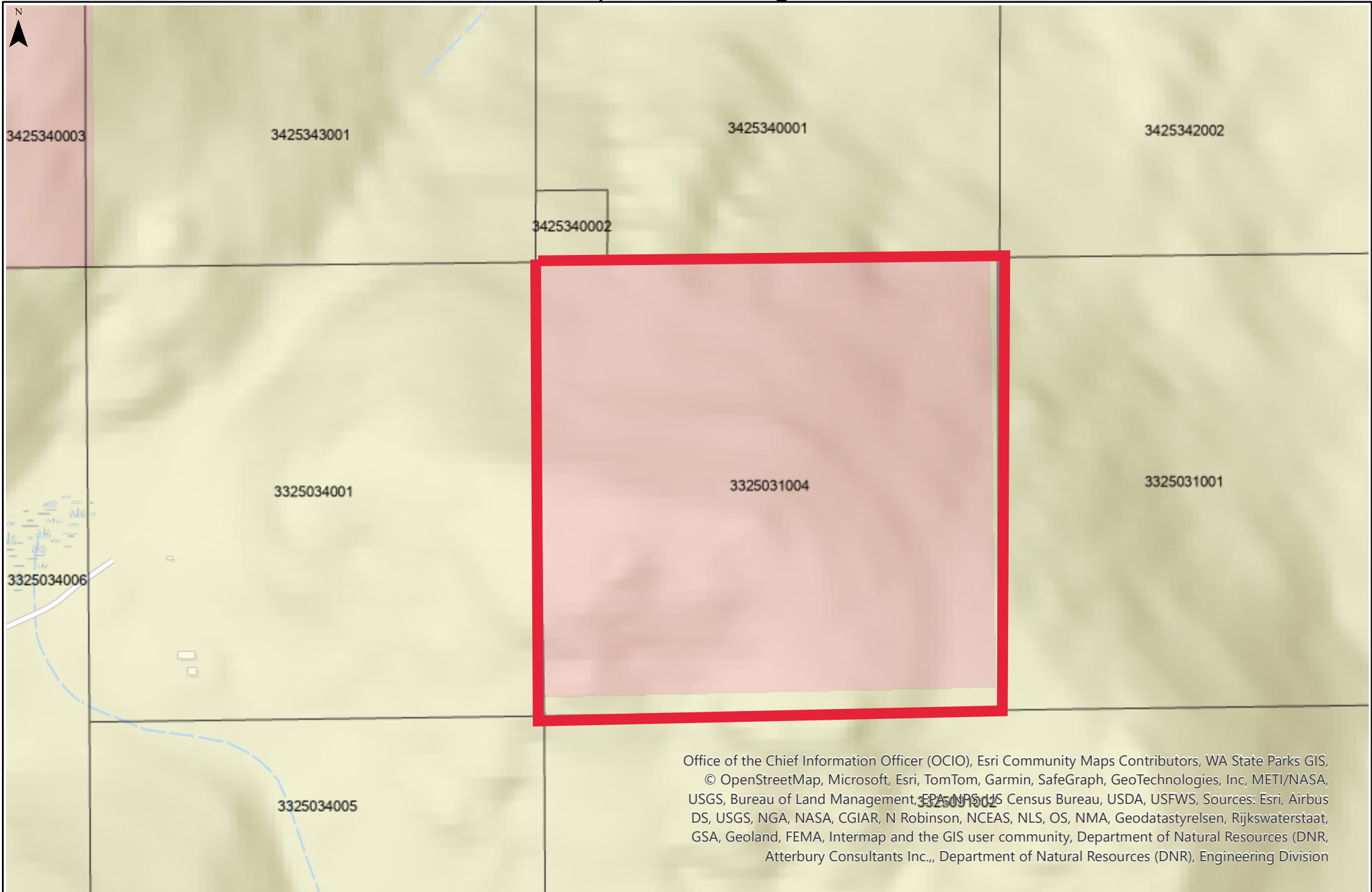

Office of the Chief Information Officer (OCIO), Esri Community Maps Contributors, WA State Parks GIS, © OpenStreetMap, Microsoft, Esri, TomTom, Garmin, SafeGraph, GeoTechnologies, Inc, METI/NASA, USGS, Bureau of Land Management, EPA, NPS, US Census Bureau, USDA, USFWS, Sources: Esri, Airbus DS, USGS, NGA, NASA, CGIAR, N Robinson, NCEAS, NLS, OS, NMA, Geodatastyrelsen, Rijkswaterstaat, GSA, Geoland, FEMA, Intermap and the GIS user community, Department of Natural Resources (DNR, Atterbury Consultants Inc., Department of Natural Resources (DNR), Engineering Division

Approximate Scale : 1:4,514

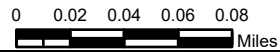

7/17/2024 1:24 PM

Coordinate System: NAD 1983 HARN StatePlane Washington South FIPS 4602 Feet



WASHINGTON STATE DEPT OF
**NATURAL
RESOURCES**

Extreme care was used during the compilation of this map to ensure accuracy. However, due to changes in data and the need to rely on outside information, the Department of Natural Resources cannot accept responsibility for errors or omissions, and therefore, there are no warranties which accompany this material.