



**Northwest Region
Firewood Cutting Permit**

**Expires: March 15, 2012
Famous Horse**

A Discover Pass is required to access DNR recreation lands. For information on how to purchase the pass, visit www.discoverpass.wa.gov or call 1-866-320-9933. Find out where you'll need a Discover Pass on DNR-managed state trust lands at www.dnr.wa.gov/recreation.

Permit must be in vehicle window and available upon request

Do not cut any standing trees, snags, or blow-down timber.

Only cut within the boundaries of the unit(s) outlined on the map, and only within 200 feet from truck roads. Units available for firewood cutting are marked on the map with //// in the interior of the unit.

Roads are planned for abandonment. Roads may be abandoned at any time. The exact timeline is unknown and not controlled by the department.

Firewood is for personal use only

- 1) Limit of 6 cords per family with this permit.
- 2) Cut only wood that is dead and on the ground.
- 3) Cedar is not authorized for removal.

Obey all signs posted in the unit

- 5) Do not disturb ANY planted seedlings.
- 6) Motorized equipment and/or vehicles must stay on roads (do not drive on skid trails).
- 7) **No removal or cutting of firewood is allowed more than 200 feet from truck roads.**
- 8) **Do not cut firewood on the road. Keep road surface and ditches clean.**

Any false statement made in this application or violation of these terms is punishable as a Gross Misdemeanor.

RCW 79.15.440

This permit may be voided by any State DNR Forester on demand.

The firewood area will be closed if abuse or permit violations occur.

Please report any violations to DNR Northwest Region, 360-856-3500; Report Fires 1-800-562-6010.

A DISCOVER PASS IS REQUIRED FOR THIS FIREWOOD CUTTING AREA. Please visit www.discoverpass.wa.gov to find more about the Discover Pass, including where you can purchase a pass.

The following information must be provided to validate this permit:

Name: _____

Address: _____

Phone Number: _____ Vehicle Make/Model/Color: _____

This permit expires: March 15, 2012

FW = FIREWOOD PERMIT AREA

TIMBER SALE MAP

SALE NAME: Famous Horse
AGREEMENT#: 30-082087
LEGAL: T28R07E, T29R07E
TRUST(S): State Forest Transfer Lands(01)

REGION: Northwest
COUNTY(S): Snohomish
ELEVATION RGE: 400-1000'

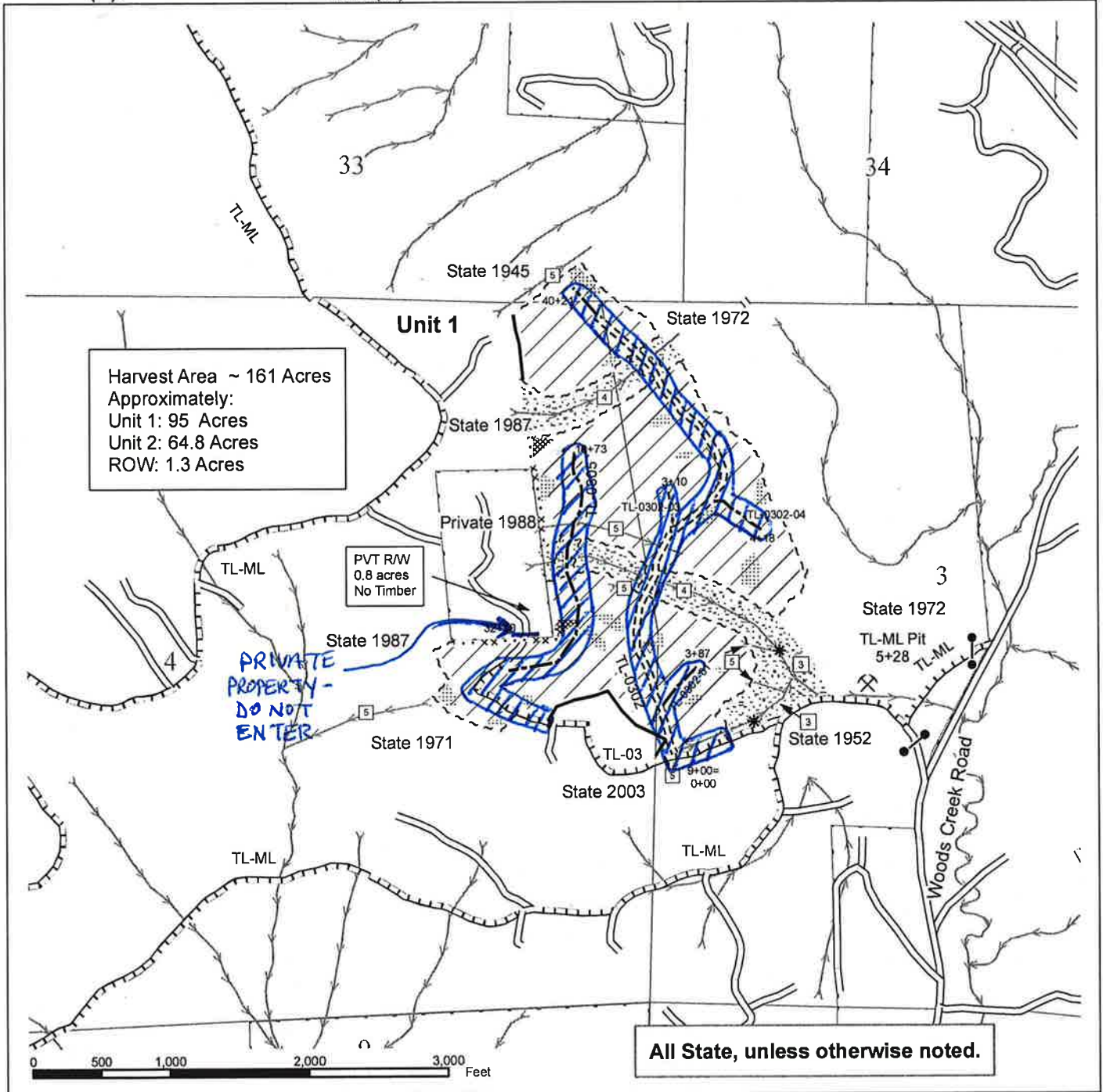

Sale Area	Optional Reconstruction	DNR Managed Lands
Water Type Break	Optional Construction	Public Land Survey Sections
Stream Type	Required Construction	Streams
Gate	Roads	Open Water
Rock Pit	Required Reconstruction	Leave Tree Clump
Waste Area	Timber Sale Boundary Tags	RMZ
Leave Tree Clump (Not to be Traded)	Right-Of-Way Tags	
	Special Management Tags	
	Sale Boundary (Reprod)	



TIMBER SALE MAP

 = FIREWOOD PERMIT AREA

SALE NAME: Famous Horse
 AGREEMENT#: 30-082087
 LEGAL: T28R07E, T29R07E
 TRUST(S): State Forest Transfer Lands(01)

REGION: Northwest
 COUNTY(S): Snohomish
 ELEVATION RGE: 400-1000'

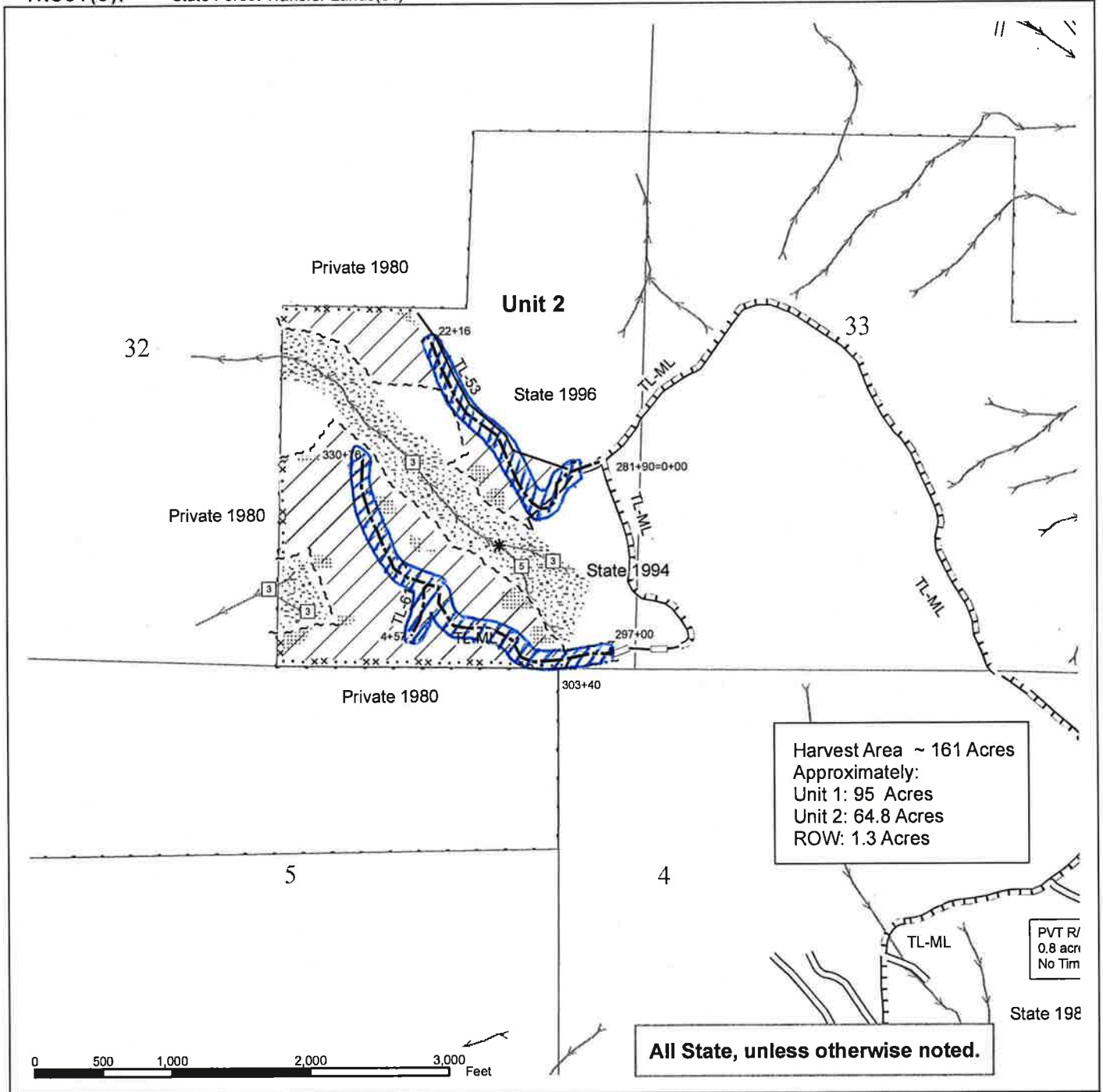

Harvest Area ~ 161 Acres
 Approximately:
 Unit 1: 95 Acres
 Unit 2: 64.8 Acres
 ROW: 1.3 Acres

All State, unless otherwise noted.

PVT R/
 0.8 acr
 No Tim

 Sale Area	 Optional Reconstruction	 DNR Managed Lands
* Water Type Break	 Optional Construction	 Public Land Survey Sections
 Stream Type	 Required Construction	 Streams
● Gate	 Roads	 Open Water
✕ Rock Pit	 Required Reconstruction	 Leave Tree Clump
 Waste Area	 Timber Sale Boundary Tags	 RMZ
 Leave Tree Clump (Not to be Traded)	 Right-Of-Way Tags	
	 Special Management Tags	
	 Sale Boundary (Reprod)	

DRIVING MAP

SALE NAME: Famous Horse
AGREEMENT#: 30-082087
TOWNSHIP(S): T28R07E, T29R07E
TRUST(S): State Forest Transfer Lands(01)

REGION: Northwest
COUNTY(S): Snohomish
ELEVATION RGE: 400-1000

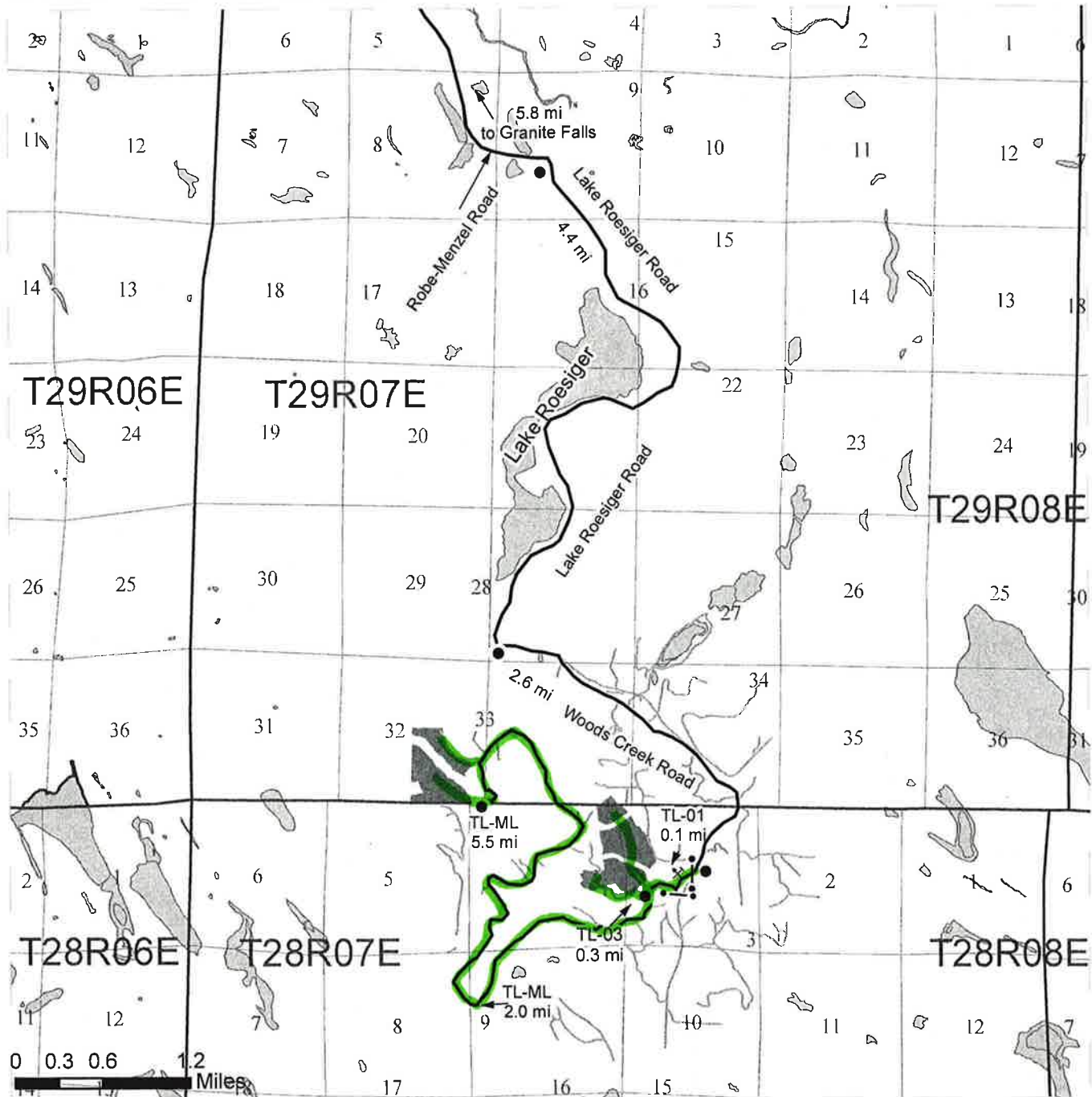

- Haul Route
- Timber Sale Unit
- Open Water
- Gate
- Rock Pit
- Distance Indicator

DRIVING DIRECTIONS:

From Granite Falls, WA travel south 5.8 miles on Robe-Menzel Road.
 Turn right onto Lake Roesiger Road and travel south 4.4 miles.
 Turn left onto Woods Creek Road and travel south 2.6 miles.
 Turn right onto TL-ML .
 From TL-ML gate travel 0.3 miles, Unit 1 will be on right.
 To access Unit 2 travel 5.5 miles to end of TL-ML.
 Unit 2 will be to the west.

