



WASHINGTON STATE DEPARTMENT OF
Natural Resources
PETER GOLDMARK - Commissioner of Public Lands

State Trust Parcel in Whatcom County

Kickerville West

PARCEL NUMBERS: 390117334462, 390117334328, 390117473326

LEGAL DESCRIPTION: 17-39N-1E

LOCATION: County – Major Port Industrial UGA

SIZE: 160 Acres

SURROUNDING LAND USES: Industrial and residential

ZONING: HII (Heavy Impact Industrial)

ACCESS: Public

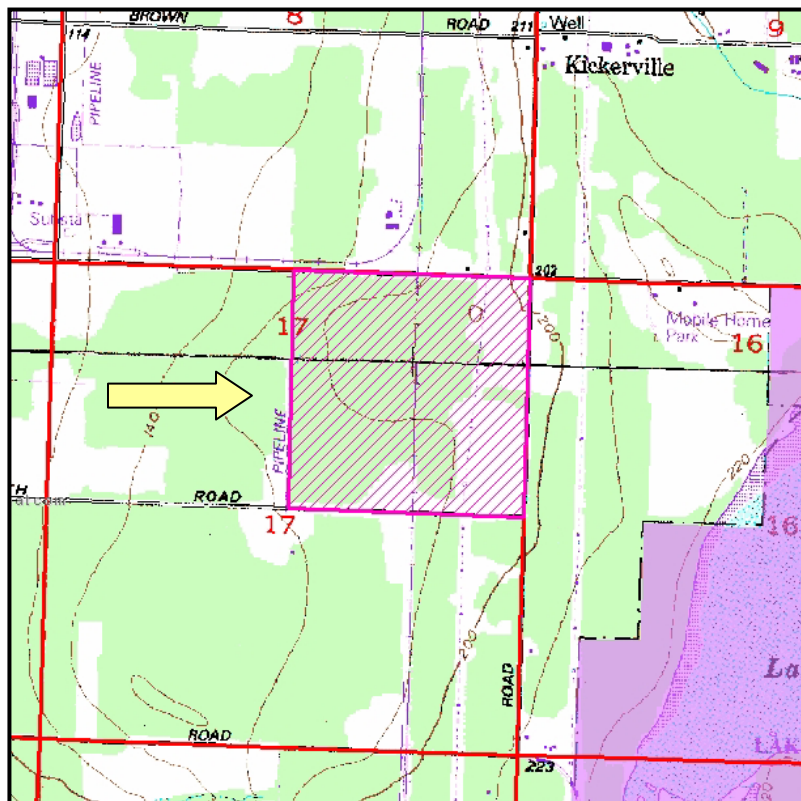

This information has been obtained from sources considered reliable but the State specifically disclaims any warranties, express or implied, that the information provided herein is accurate. Information may be changed without notice.