



WASHINGTON STATE DEPARTMENT OF
Natural Resources
PETER GOLDMARK - Commissioner of Public Lands

State Trust Parcel in Snohomish County

SISCO 36

PARCEL NUMBER: 31053600100300
LEGAL DESCRIPTION: 36-31N-5E
LOCATION: 5 miles south of Arlington – bisected by Highway 9
SIZE: 240 Acres
SURROUNDING LAND USES: Rural Residential
ZONING: R5
ACCESS: County Road

UTILITIES

Water:	Unknown
Sewer:	Septic
Power:	Available

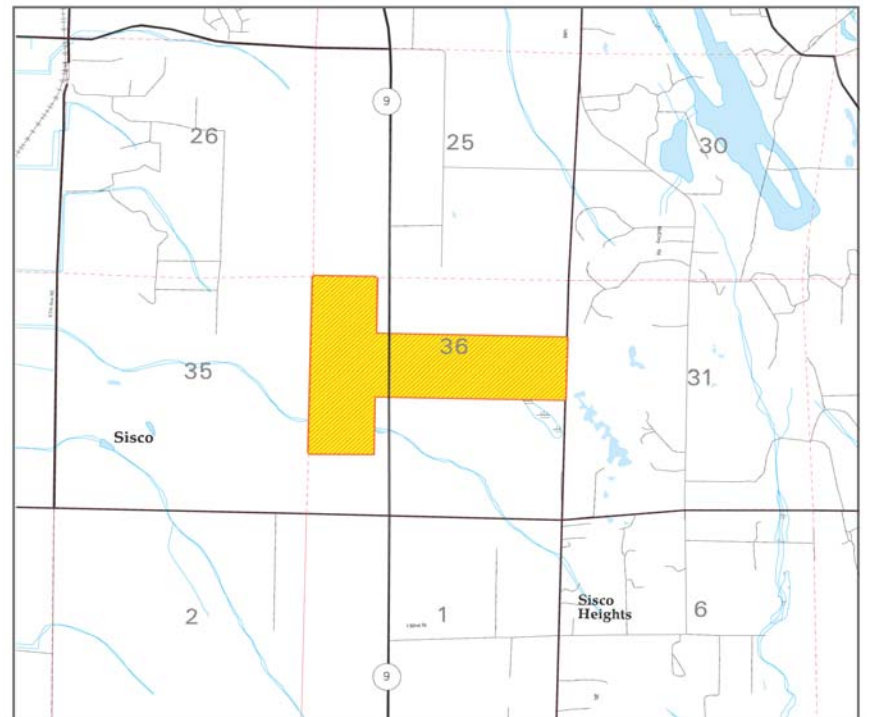

This information has been obtained from sources considered reliable but the State specifically disclaims any warranties, express or implied, that the information provided herein is accurate. Information may be changed without notice.