



WASHINGTON STATE DEPARTMENT OF
Natural Resources
PETER GOLDMARK - Commissioner of Public Lands

State Trust Parcel in Snohomish County

LAKE STEVENS

PARCEL NUMBER: 29061600200800, 29061600301900

LEGAL DESCRIPTION: 16-29N-6E

LOCATION: Near Lake Stevens

SIZE: 124 Acres

SURROUNDING LAND USES: Residential, small farms

ZONING: R5 – 40.56 acres
SA1 – 83.08

ACCESS: County Road

UTILITIES

Water:	Well/Public
Sewer:	Septic
Power:	Available

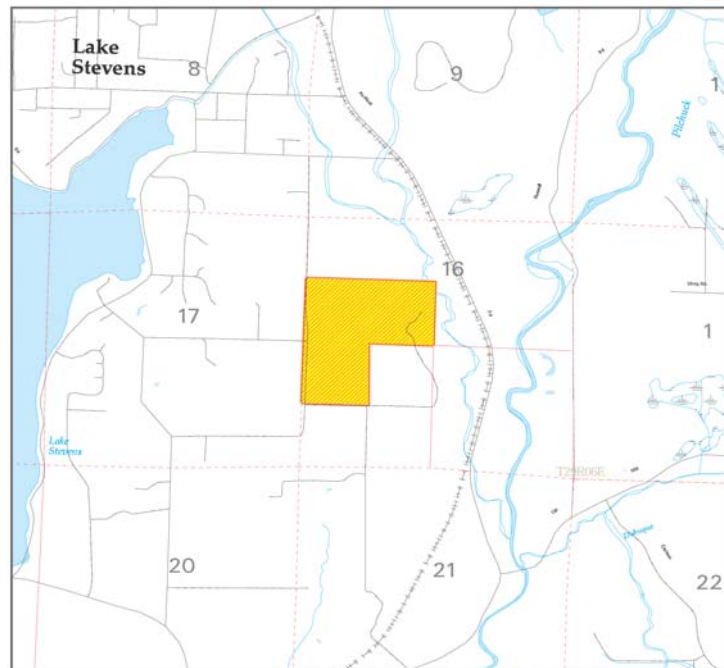

This information has been obtained from sources considered reliable but the State specifically disclaims any warranties, express or implied, that the information provided herein is accurate. Information may be changed without notice.