



WASHINGTON STATE DEPARTMENT OF
Natural Resources
PETER GOLDMARK - Commissioner of Public Lands

State Trust Parcel in King County

PROVIDENCE HEIGHTS

PARCEL NUMBER: 1624069008
LEGAL DESCRIPTION: 16-24N-6E
LOCATION: SE 43rd Way, Sammamish
SIZE: 42 Acres
SURROUNDING LAND USES: Residential
ZONING (City): R12SO
ACCESS: Public

UTILITIES

Water:	Available
Sewer:	Available
Power:	Available

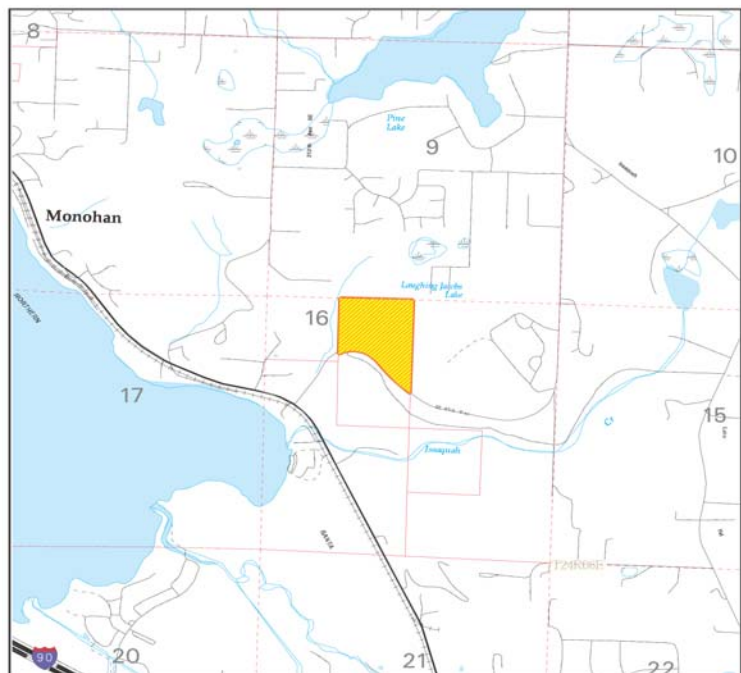

This information has been obtained from sources considered reliable but the State specifically disclaims any warranties, express or implied, that the information provided herein is accurate. Information may be changed without notice.